



# GX 550 / LC 250 / 4G Tacoma Shock Skid Install

Feedback?



**1**

Provided Hardware & Tools Needed:

(8) 5/16" Hex Bolts

(8) 1/2" Washers

(8) 5/16" Nut Tabs

1/2" Wrench

**2**

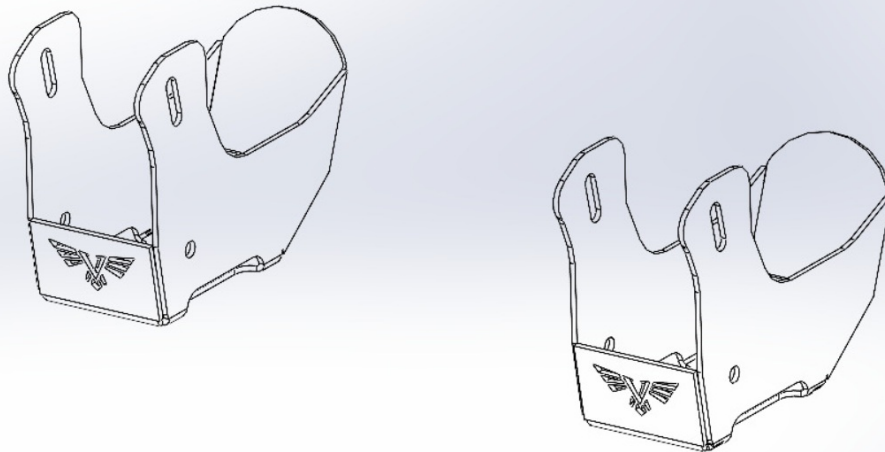

Included Parts: (2) Shock Skids

**3**

The (2) holes shown are the holes you will need to line your skid holes up to on each side of the shock, making (4) total.

**4**

Take the provided hardware and insert it through the skid into the holes stated in the previous step on each side of the skid. There is a slot in the skid to adjust height.



5

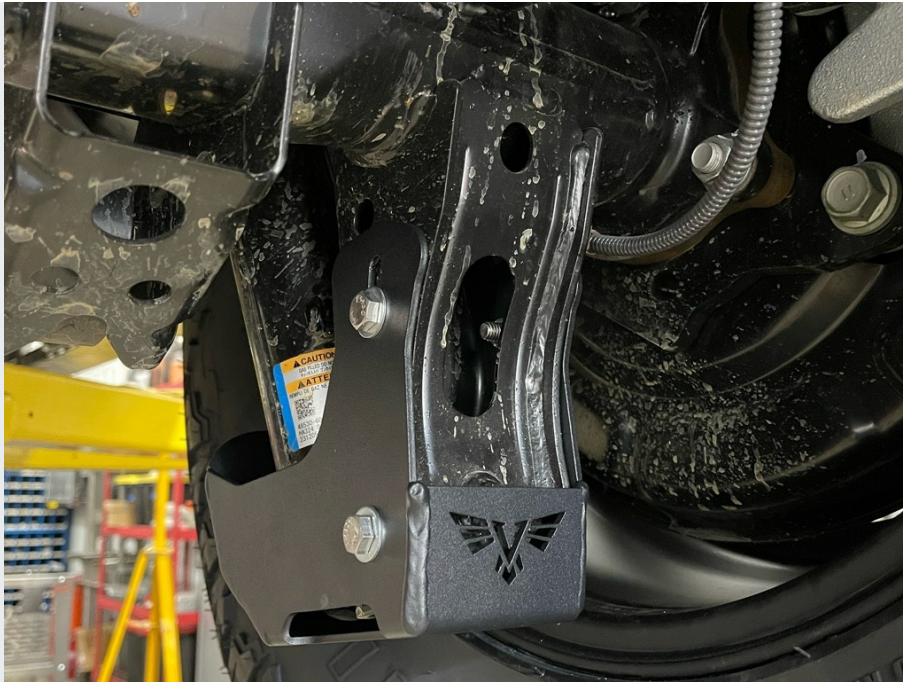

Once all (4) of your bolts are started into the nut tabs and the height is adjusted, use a 1/2" wrench and tighten them all down to finish your install.

6

**Thank you for supporting  
American-made. We hope you  
enjoy your new product!**

If you have any questions or concerns  
please reach out to us.

[info@jcroffroad.com](mailto:info@jcroffroad.com)  
[info@victory4x4.com](mailto:info@victory4x4.com)  
[info@squatch-proof.com](mailto:info@squatch-proof.com)  
[info@fatamericanmfg.com](mailto:info@fatamericanmfg.com)

269-353-1184

